

## Assembling Folding Space-Station Interior "E"

### The Cargo Bay

This module includes a cargo storage bay with small air lock, a matter transporter, the station's master computers, and storage cabinets for spare parts. The central aisle is the only way to get from left side to right; the top and bottom corridors are dead ends, and the machinery spaces behind them can be reached only through the ventilation ducts. A rather busy section, all in all.

Print one copy of each page. Assemble the walls and floor just like any of the other space-station interiors. The short walls should be attached in order from top to bottom.

Glue the computer cabinets and spare-parts cabinets to their designated places on the floors and folding walls. The small panel for the matter transporter goes on the floor and wall next to the transporter grid. It looks like this when done:

```
#####
#   +   V #
Wall 1 # -|-+|-|#   "+" signs are doors
# @|c c| #   "@" are teleport grids
# slc c| #   "s" are small control panels
2 # -|-+|-|+#   "p" is cabinets for spare parts
#   +   + #   "c" is computers
3 # -|-+|-|+#   "V" is vents giving access to machinery spaces
# pl   | #
# pl   | #
# pl   | #
4 # -|++-|V#
#   +   | #
#####
```

You'll have to supply your own cargo materials.

To get the best effect from this interior, the outer walls must be glued together so the letters on the tabs are in order, going clockwise. This gets the

instrument

panels in the corners, hidden by the sliding vents. Thus, the instrument panels are something hard to get to, but which might be very important to your adventure.

By Cke1st (Mike Fischer)

Original concept and artwork by Gerrit Postma. All rights reserved.

### Folding SF Interior E - Walls - 1

Original by: Gungnir  
Modified by: Ckelst

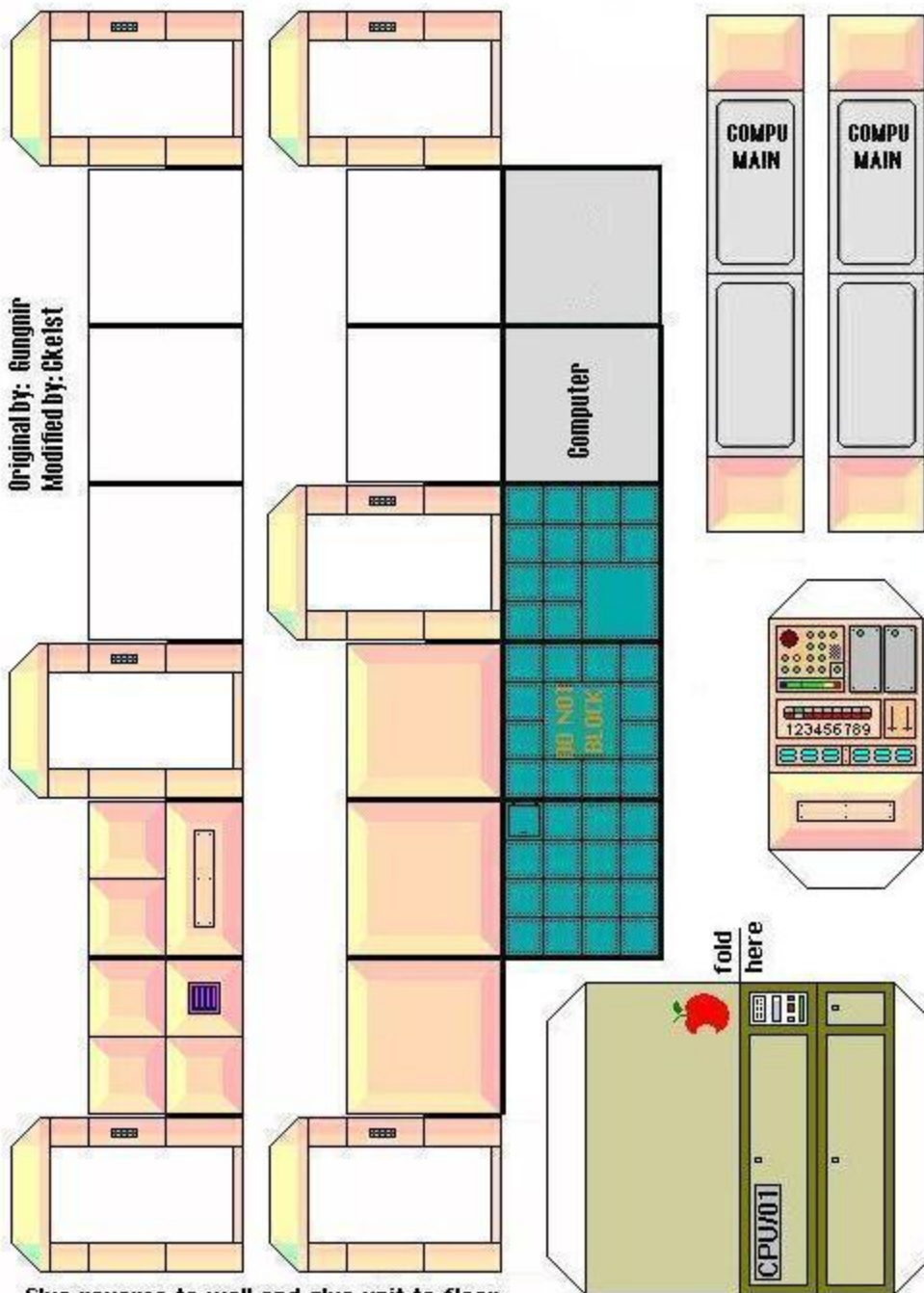

**Glue reverse to wall and glue unit to floor.**

# Folding SF Interior E - Walls - 2

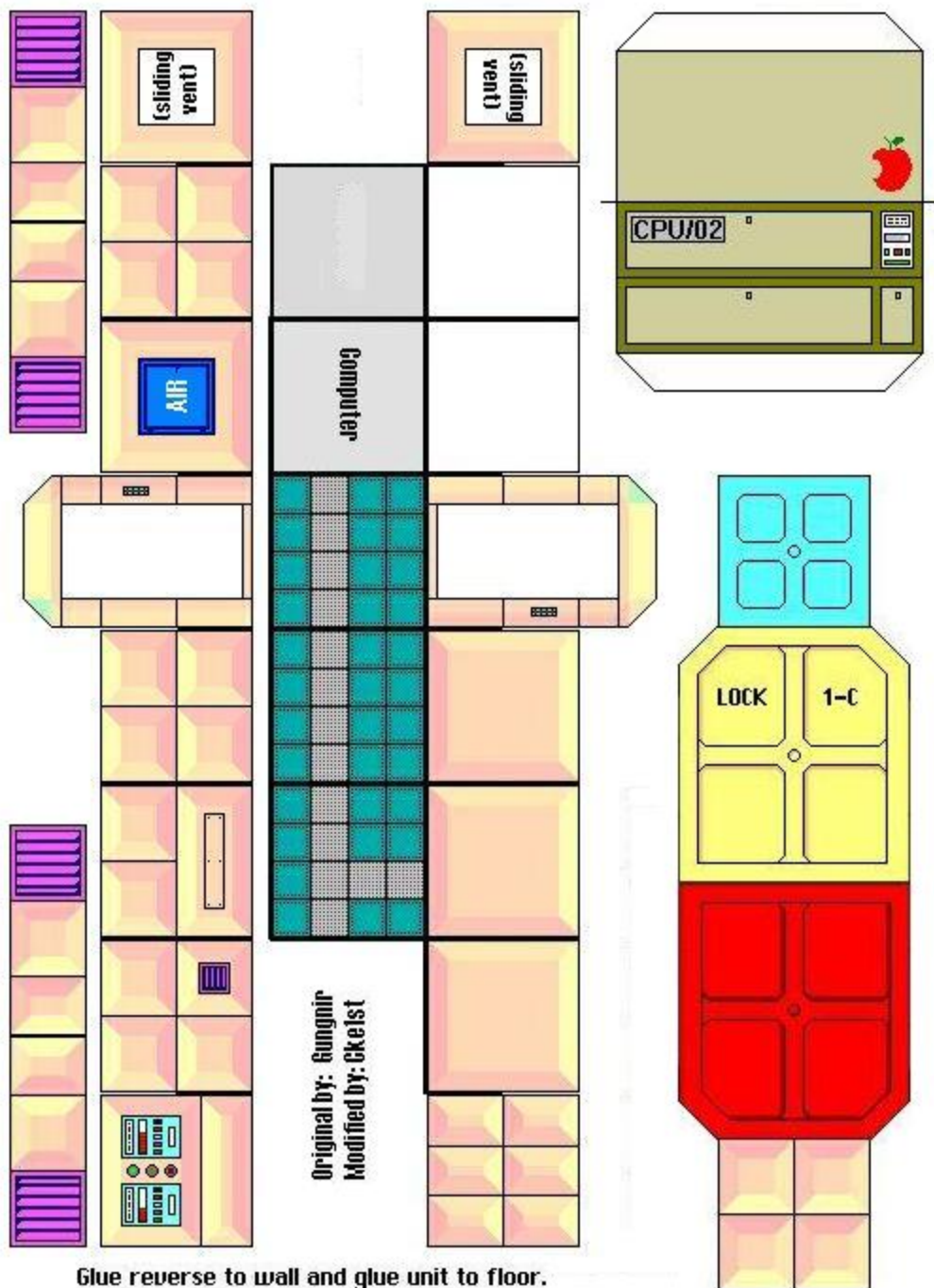

Original by: Rungnir  
Modified by: Cke1st

# Folding SF Interior E-Walls-3

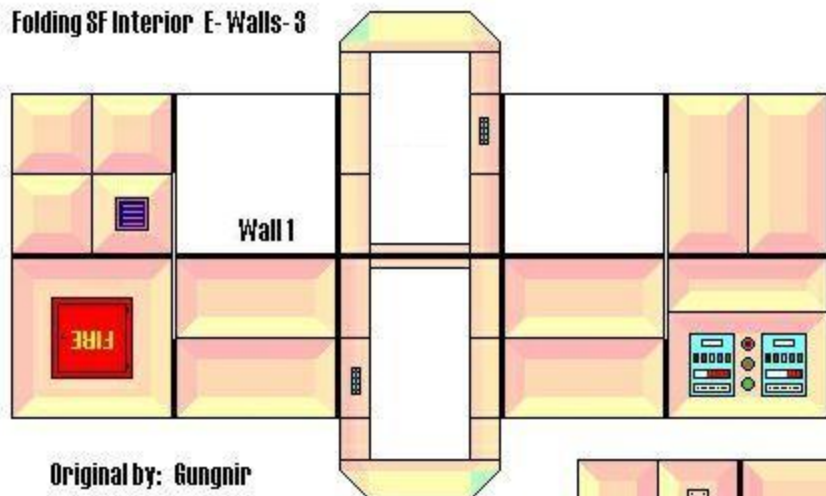

Original by: Gungnir  
Modified by: Ckelst

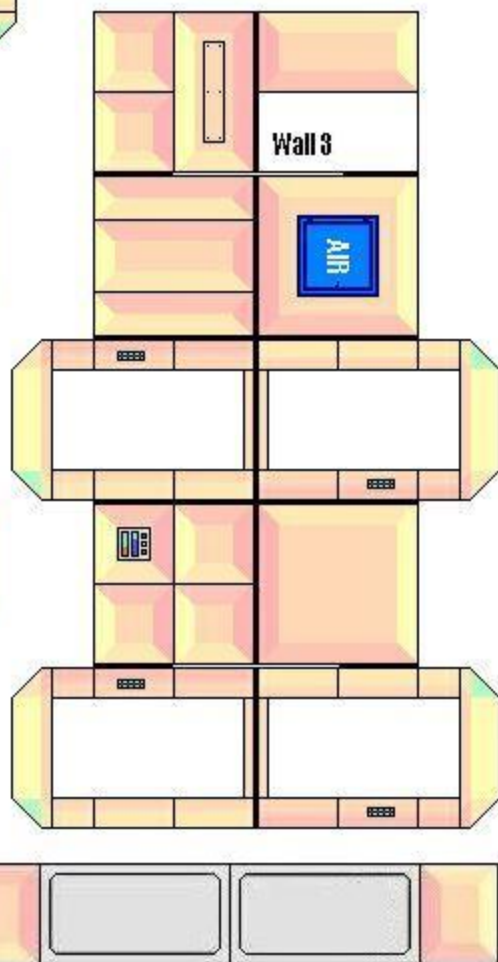
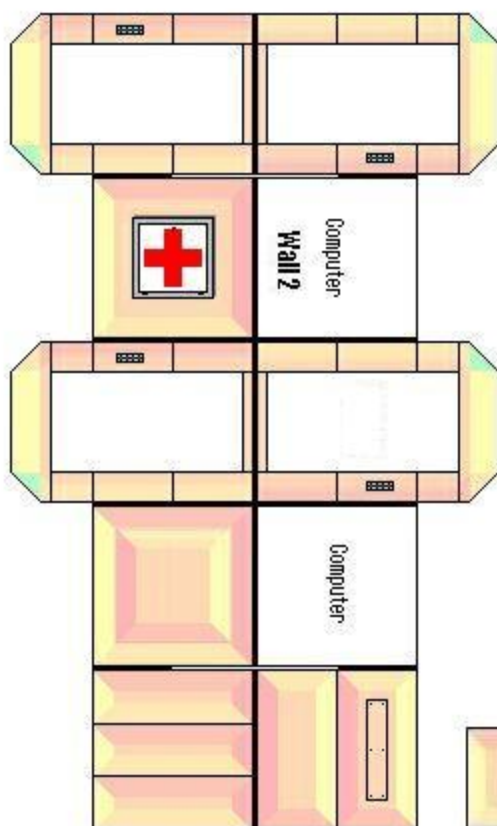

# Folding SF Interior E-Walls - 4

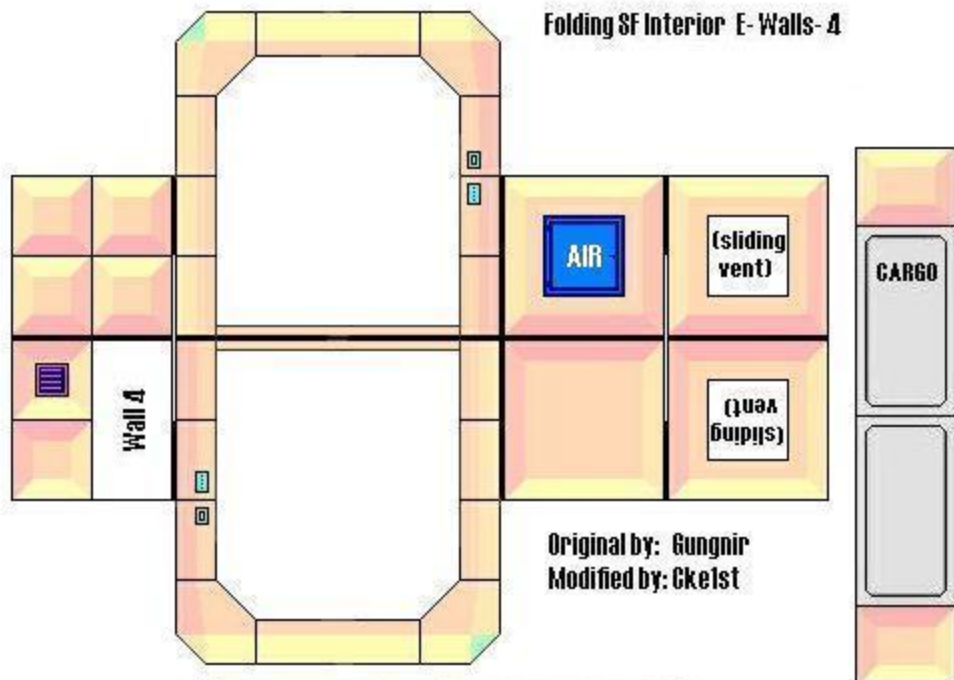

Original by: Gungnir  
Modified by: Ckelst

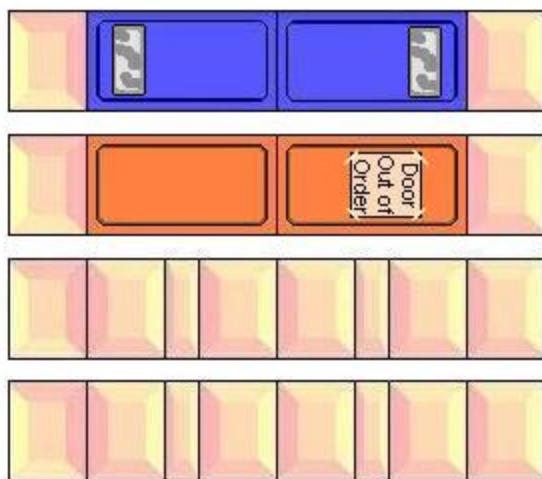
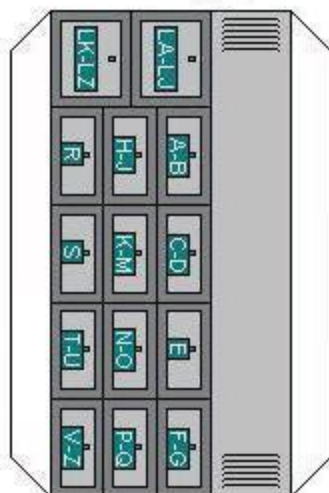
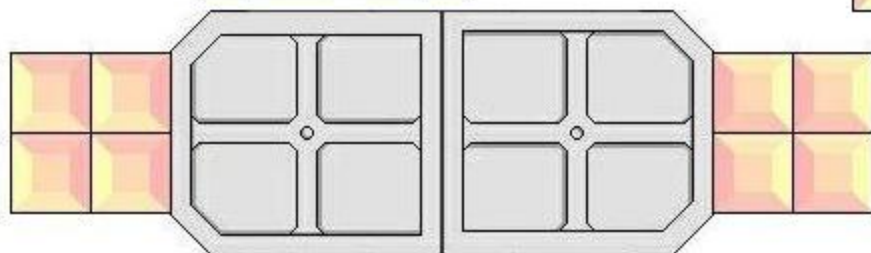

# Folding SF interior E- Floor

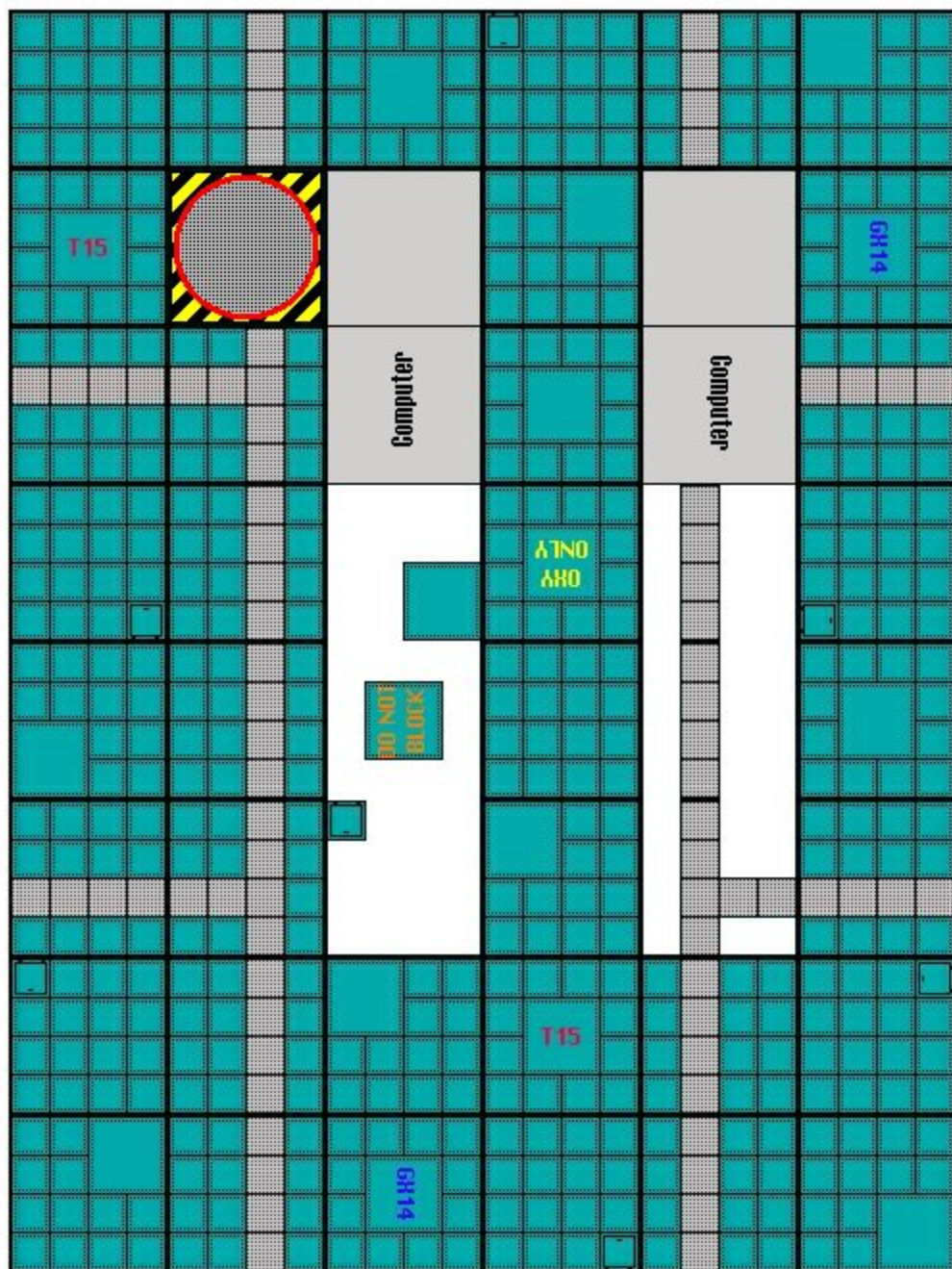

Original by: Gungnir

Modified by: Cke1st

# Folding SF Interior E - Outer Walls 1

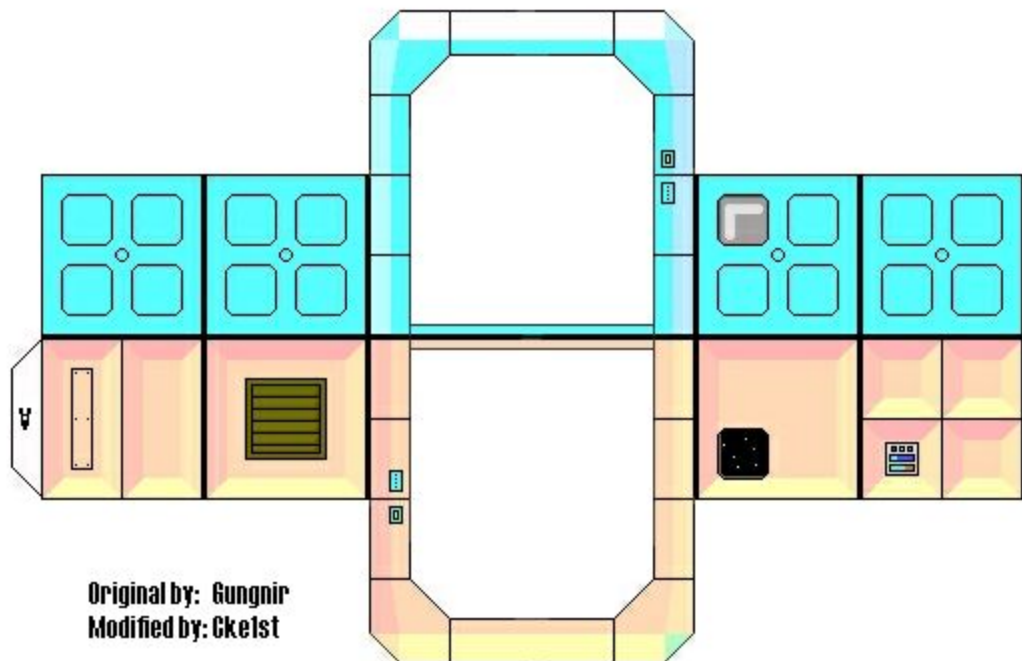

Original by: Gungnir  
Modified by: Ckelst

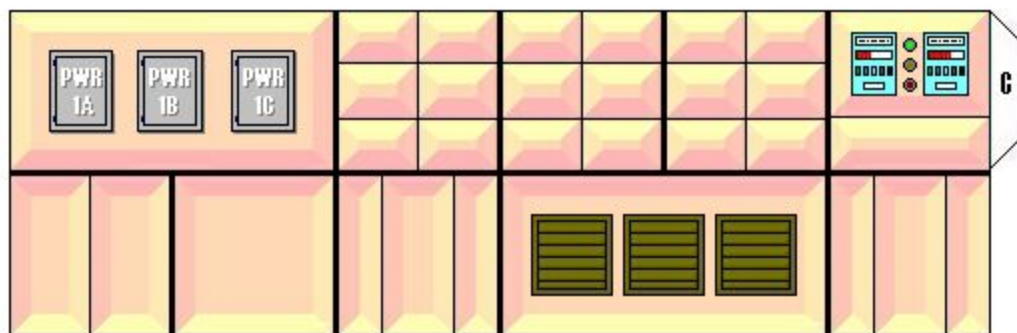

# Folding SF Interior E - Outer Walls 2

Original by: Bungair  
Modified by: Ckrist

